

Microsoft

Exam Questions PL-500

Microsoft Power Automate RPA Developer



NEW QUESTION 1

- (Exam Topic 1)

You need to ensure that the solution uses the correct accounts payable mailbox. Which three actions should you perform? Each correct answer part of the solution, NOTE: Each correct selection is worth one point.

- A. Set the current value for the accounts payable mailbox in the environment.
- B. Set the default value for the accounts payable mailbox in the environment.
- C. Turn off and then turn on the cloud flows.
- D. Use separate environment variables for the cloud flow and the canvas app.
- E. Use one environment variable for both the cloud flows and the canvas app.

Answer: ACD

NEW QUESTION 2

- (Exam Topic 1)

You need to configure the solution.

What should you use? To answer, select the appropriate options in the answer area. NOTE: Each correct selection is worth one point.

Answer Area

Requirement	Option
Automate the SMSApp data entry process.	<input type="checkbox"/> Action <input type="checkbox"/> Workflow <input type="checkbox"/> Desktop flow <input type="checkbox"/> Mobile task flow
Handle invoices sent to the Accounts payable mailbox.	<input type="checkbox"/> When a folder is created <input type="checkbox"/> When an item is created <input type="checkbox"/> When a new email arrives <input type="checkbox"/> When a new email arrives in a shared mailbox
Implement the order process.	<input type="checkbox"/> Workflows <input type="checkbox"/> Instant flows <input type="checkbox"/> Business rules <input type="checkbox"/> Business process flows

Solution:

Answer Area

Requirement	Option
Automate the SMSApp data entry process.	<input type="checkbox"/> Action <input checked="" type="checkbox"/> Workflow <input checked="" type="checkbox"/> Desktop flow <input type="checkbox"/> Mobile task flow
Handle invoices sent to the Accounts payable mailbox.	<input type="checkbox"/> When a folder is created <input type="checkbox"/> When an item is created <input checked="" type="checkbox"/> When a new email arrives <input type="checkbox"/> When a new email arrives in a shared mailbox
Implement the order process.	<input checked="" type="checkbox"/> Workflows <input type="checkbox"/> Instant flows <input type="checkbox"/> Business rules <input type="checkbox"/> Business process flows

Does this meet the goal?

- A. Yes
- B. No

Answer: A

NEW QUESTION 3

- (Exam Topic 1)

You need to determine the causes for the reported issues.

What are the causes? To answer, select the appropriate options in the answer area. NOTE: Each correct selection is worth one point.

Issue	Cause
New environment	Flow checker did not run. Admin mode is turned on. Admin mode is turned off. A connector was added to a DLP policy.
FlowA	The user is in the wrong environment. The user does not have the correct permissions.
Dataverse error	There is no Microsoft Dataverse database provisioned. The user did not sign into Power Automate by using a Microsoft work account. Microsoft Dataverse was not shared with the user from the development environment.

Solution:

Issue	Cause
New environment	Flow checker did not run. Admin mode is turned on. Admin mode is turned off. A connector was added to a DLP policy.
FlowA	The user is in the wrong environment. The user does not have the correct permissions.
Dataverse error	There is no Microsoft Dataverse database provisioned. The user did not sign into Power Automate by using a Microsoft work account. Microsoft Dataverse was not shared with the user from the development environment.

Does this meet the goal?

- A. Yes
- B. No

Answer: A

NEW QUESTION 4

- (Exam Topic 1)

You need to implement security to resolve the invoice data issue

Which three actions should you perform? Each correct answer presents part of the solution. NOTE: Each correct selection is worth one point.

- A. Select the Finance role, select Core Records, and then navigate to the table.
- B. Clear the Create and Delete permission
- C. Set the Read permission and Write permission values to Business unit D
- D. In Microsoft Power Platform admin center, navigate to the Security roles section.
- E. In Microsoft Power Platform admin center, navigate to the Users section.
- F. Select the Finance role, select Custom Entities and navigate to the table.
- G. Clear the Create and Delete permission
- H. Set the Read permission and Write permission values to Organization.

Answer: ACF

NEW QUESTION 5

- (Exam Topic 2)

You need to identify the actions that PipelineManager1 can perform.

Which three actions can PipelineManager1 perform? Each correct answer presents a complete solution. NOTE: Each correct selection is worth one point.

- A. Override the DLP policy.
- B. Modify or delete a flow.
- C. Modify the owner's connection credentials.
- D. View the run history.
- E. Set the cloud flow priority.
- F. Add or remove other owners.

Answer: CDF

NEW QUESTION 6

- (Exam Topic 3)

You plan to implement a data loss prevention (DLP) policy for a production environment. You need to define the policy.

Which four actions should you perform in sequence? To answer, move the appropriate actions from the list of actions to the answer area and arrange them in the correct order.

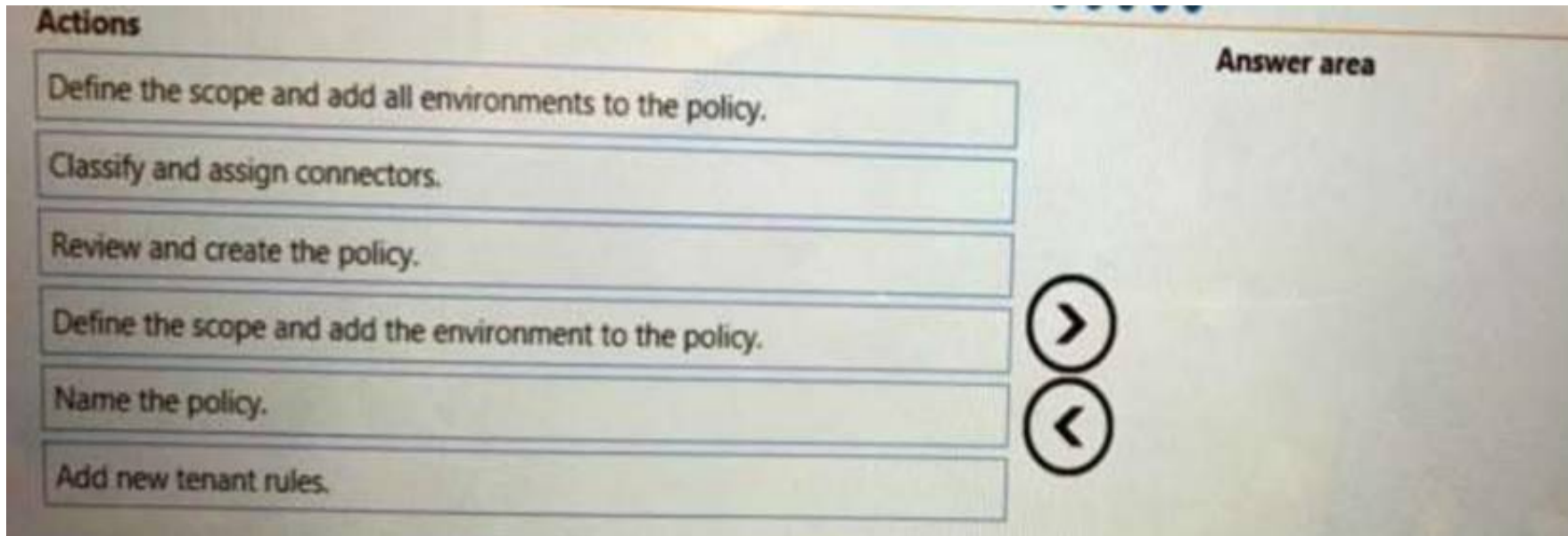

Solution:

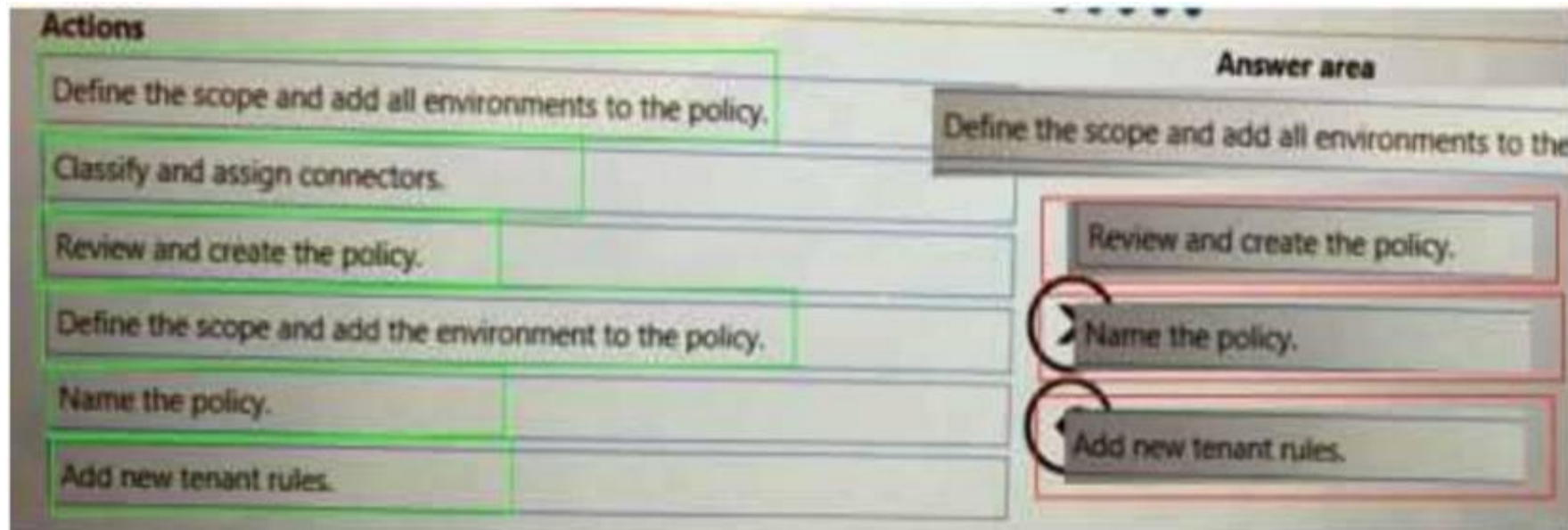

Does this meet the goal?

- A. Yes
- B. No

Answer: A

NEW QUESTION 7

- (Exam Topic 3)

You are developing automation solutions for a company.

You need to use Microsoft Office scripts in a cloud flow to calculate the number of business days between two dates.

Which three actions should you perform in sequence?

To order, answer, move the appropriate actions from the list of actions to the answer area and arrange them in the correct order.

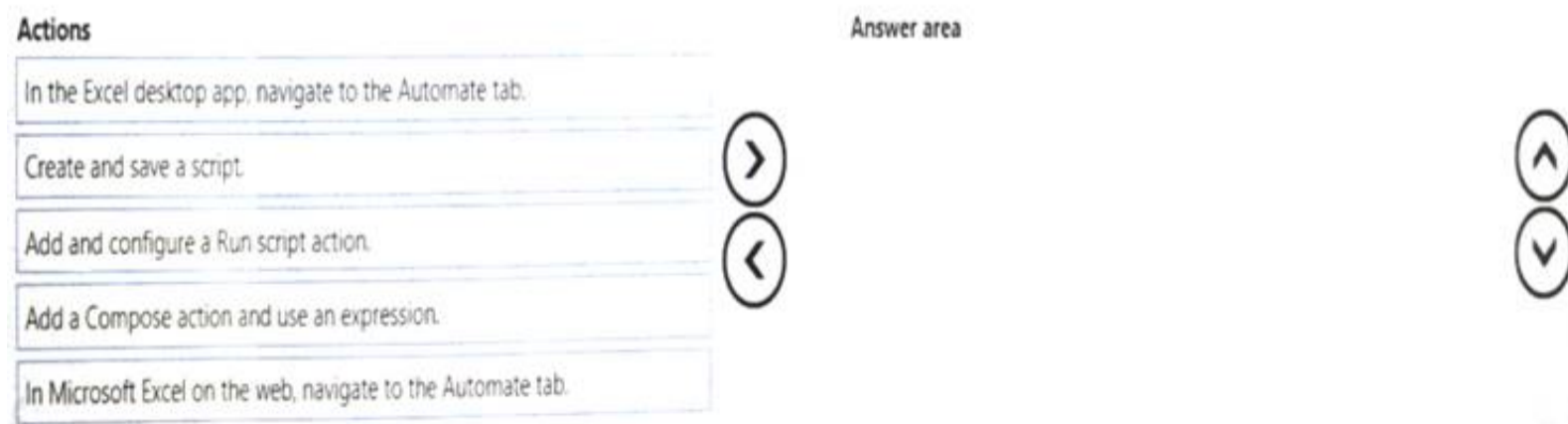

Solution:

Actions

- In the Excel desktop app, navigate to the Automate tab.
- Create and save a script.
- Add and configure a Run script action.
- Add a Compose action and use an expression.
- In Microsoft Excel on the web, navigate to the Automate tab.

Answer area

- Add and configure a Run script action.
- Create and save a script.
- In the Excel desktop app, navigate to the Automate tab.

Does this meet the goal?

- A. Yes
- B. No

Answer: A

NEW QUESTION 8

- (Exam Topic 3)

You are trying to record the process that a hospitality facility uses to check in patients. You need to identify bottlenecks and variations in the process. What should you use?

- A. Process Advisor
- B. Flow checker
- C. AI Builder
- D. Solution checker

Answer: D

NEW QUESTION 9

- (Exam Topic 3)

A developer creates a desktop flow. You need to debug the flows.

Which debugging tools should you use? To answer, select the appropriate options in the answer area. NOTE: Each correct selection is worth one point.

Answer Area

Scenario	Debugging tool
Run each action and then pause the flow after the action completes. Open the variables pane to check a value before continuing the flow.	<ul style="list-style-type: none"> Run delay Find in code Run from here Run next action
Automatically stop the flow at a specific action.	<ul style="list-style-type: none"> Pause Run delay Stop flow Breakpoint
Define the time that the flow pauses after running each action.	<ul style="list-style-type: none"> Run delay Run from here Run next action Wait for process

Solution:

Answer Area

Scenario	Debugging tool
Run each action and then pause the flow after the action completes. Open the variables pane to check a value before continuing the flow.	Run delay Find in code Run from here Run next action
Automatically stop the flow at a specific action.	Pause Run delay Stop flow Breakpoint
Define the time that the flow pauses after running each action.	Run delay Run from here Run next action Wait for process

Does this meet the goal?

- A. Yes
- B. No

Answer: A

NEW QUESTION 10

- (Exam Topic 3)

You are developing a cloud flow.

The flow must be able to query several Azure endpoints and must use standard actions where possible. You need to configure the flow.

Which actions should you use? To answer, select the appropriate options in the answer area. NOTE: Each correct selection is worth one point.

Requirement	Action
Issue POST requests to the Microsoft Graph API by using application permissions.	HTTP HTTP with Azure AD Send an HTTP request to SharePoint Office 365 groups send an HTTP request
Issue GET requests to the Microsoft Graph API by using delegated permissions.	HTTP HTTP with Azure AD Send an HTTP request to SharePoint Office 365 groups send an HTTP request
Issue GET requests to the SharePoint REST API by using delegated permissions.	HTTP HTTP with Azure AD Send an HTTP request to SharePoint Office 365 groups send an HTTP request
Issue GET requests to the SharePoint REST API by using delegated permissions.	HTTP HTTP with Azure AD Send an HTTP request to SharePoint Office 365 groups send an HTTP request
Issue POST requests to SharePoint REST API by using application permissions.	HTTP HTTP with Azure AD Send an HTTP request to SharePoint Office 365 groups send an HTTP request

Solution:

Requirement	Action
Issue POST requests to the Microsoft Graph API by using application permissions.	HTTP HTTP with Azure AD Send an HTTP request to SharePoint Office 365 groups send an HTTP request
Issue GET requests to the Microsoft Graph API by using delegated permissions.	HTTP HTTP with Azure AD Send an HTTP request to SharePoint Office 365 groups send an HTTP request
Issue GET requests to the SharePoint REST API by using delegated permissions.	HTTP HTTP with Azure AD Send an HTTP request to SharePoint Office 365 groups send an HTTP request
Issue GET requests to the SharePoint REST API by using delegated permissions.	HTTP HTTP with Azure AD Send an HTTP request to SharePoint Office 365 groups send an HTTP request
Issue POST requests to SharePoint REST API by using application permissions.	HTTP HTTP with Azure AD Send an HTTP request to SharePoint Office 365 groups send an HTTP request

Does this meet the goal?

- A. Yes
- B. No

Answer: A

NEW QUESTION 11

- (Exam Topic 3)

You are developing a solution for a medical practice. The solution must use an artificial intelligence (AI) model to evaluate medical X-ray images and detect broken bones.

You need to create the AI model for the solution. Solution: Use Visual Studio to create the model.

Does the solution meet the goal?

- A. Yes
- B. No

Answer: A

NEW QUESTION 12

- (Exam Topic 3)

You are designing automation processes.

You need to configure the run mode for each automation scenario.

Which run modes should you use? To answer, drag the appropriate run modes to the correct scenarios. Each run mode may be used once, more than once, or not at all. You may need to drag the split bar between panes or scroll to view content.

NOTE: Each correct selection is worth one point.

Run modes	Answer Area	Run mode
Attended	Scenario Automate the transfer of data from a file you save locally in an active user session to an application installed on your machine. Run 10 credit card checks in parallel in a system without API. Trigger an automation to update data in a customer relationship management app after an approval process completes.	Run mode
Unattended		Run mode
		Run mode

Solution:

Run modes	Answer Area	Run mode
Attended	Scenario Automate the transfer of data from a file you save locally in an active user session to an application installed on your machine. Run 10 credit card checks in parallel in a system without API. Trigger an automation to update data in a customer relationship management app after an approval process completes.	Unattended
Unattended		Unattended
		Attended

Does this meet the goal?

- A. Yes
- B. No

Answer: A

NEW QUESTION 13

- (Exam Topic 3)

You are developing desktop flows for a company.

You need to use Recorder to record steps that you are performing in target applications.

Which recording modes will Recorder use? To answer, drag the appropriate recording modes to the correct target applications. Each recording mode may be used once, more than once, or not at all. You may need to drag the split bar between panes or scroll to view content.

NOTE: Each correct selection is worth one point.

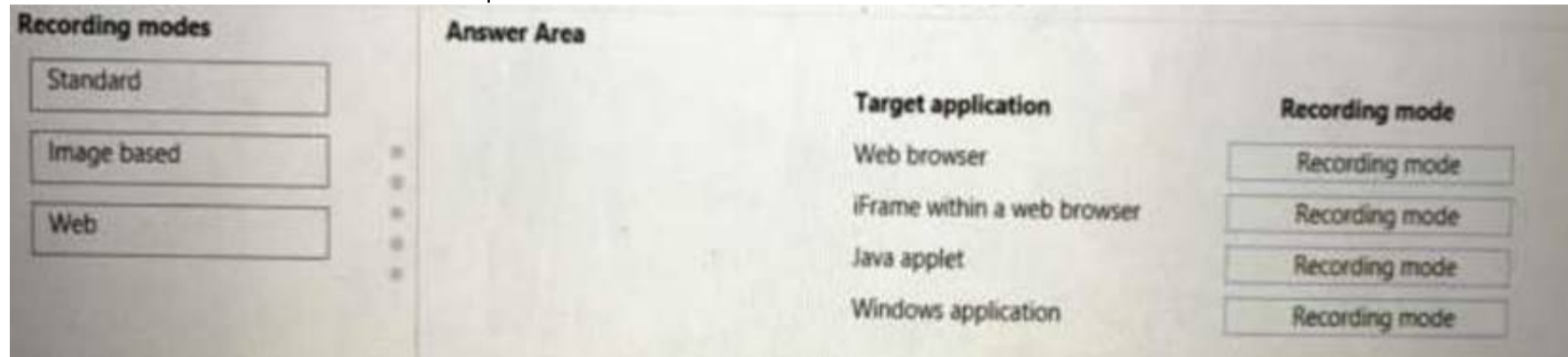

Solution:

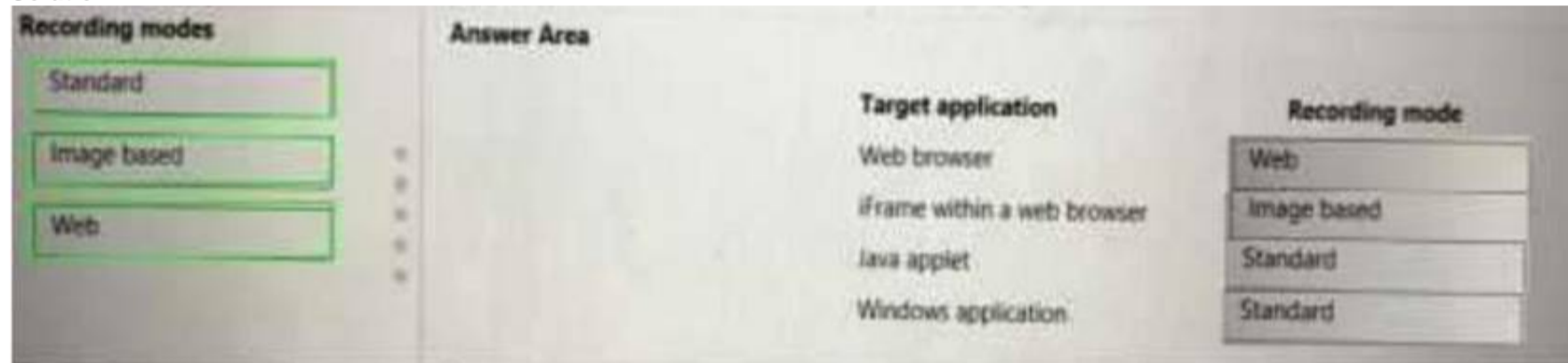

Does this meet the goal?

- A. Yes
- B. No

Answer: A

NEW QUESTION 14

- (Exam Topic 3)

A company has an unattended cloud flow solution. The solution includes a desktop flow that runs on a virtual machine.

The company reports that the cloud flow processes more transactions per day than the planned capacity.

You need to scale the solution to keep up with demand.

Which four actions should you perform in sequence? To answer, move the appropriate actions from the list of actions to the answer area and arrange them in the correct order.

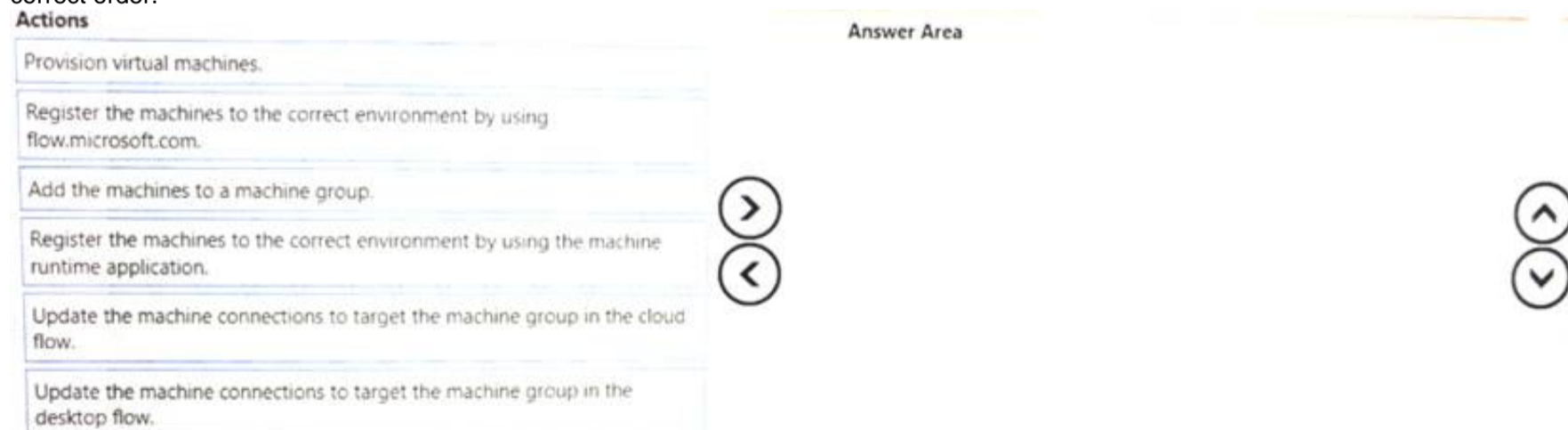

Solution:

Does this meet the goal?

- A. Yes
- B. No

Answer: A

NEW QUESTION 15

- (Exam Topic 3)

You create several desktop flows. Each flow will run on a single user's device. You need to determine how Power Automate will orchestrate the flows. Which three rules will Power Automate apply? Each correct answer presents a complete solution. NOTE: Each correct selection is worth one point.

- A. All the flows are run simultaneously.
- B. The next flow will run when each run completes based on the priority and the time requested.
- C. The first flow runs on the target device based on the priority and the time requested.
- D. The first flow runs on the target device based on Next to run status and time requested.
- E. The first and last flows run based on the priority and the time requested.
- F. The remaining flows are queued.

Answer: AEF

NEW QUESTION 16

- (Exam Topic 3)

You have a Microsoft Dataverse table in a solution. You delete fields from the table.

You need to automatically delete the fields from the Microsoft Dataverse table when you import the updated solution into a target environment. Which import option should you use?

- A. Stage for upgrade
- B. Update
- C. Upgrade

Answer: C

NEW QUESTION 17

- (Exam Topic 3)

A company has a customer relationship management (CRM) application that runs on a virtual machine (VM) in Azure.

The solution must automatically extract common invoice data from documents sent as email attachments and save the data to the company's CRM application. You need to design the solution.

In which order should you perform the actions? To answer, move all actions from the list of actions to the answer area and arrange them in the correct order.

Solution:

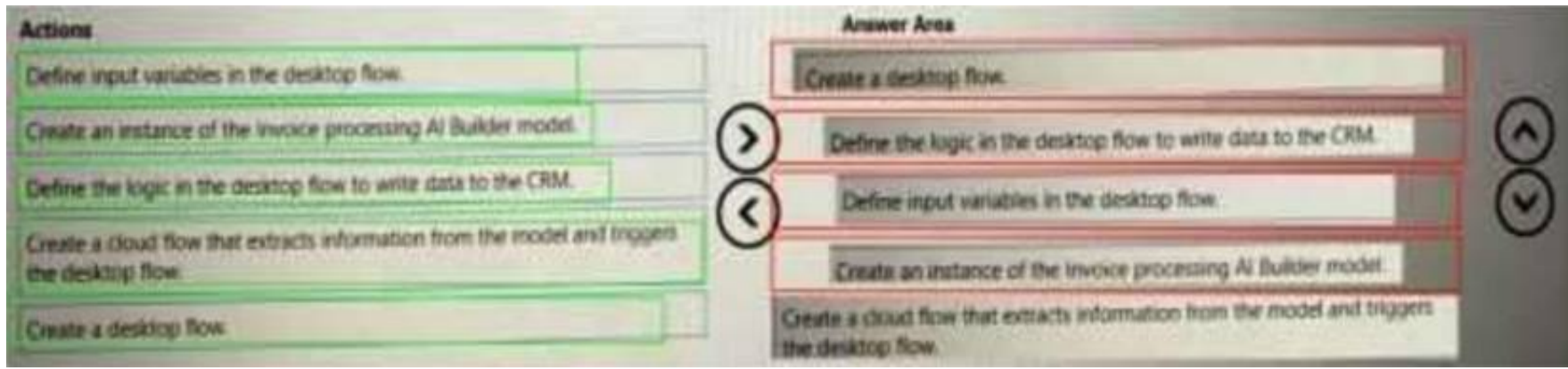

Does this meet the goal?

- A. Yes
- B. No

Answer: A

NEW QUESTION 18

- (Exam Topic 3)

You need to design automation solutions for a company.

What should you implement? To answer, select the appropriate configuration in the answer area. NOTE: Each correct selection is worth one point.

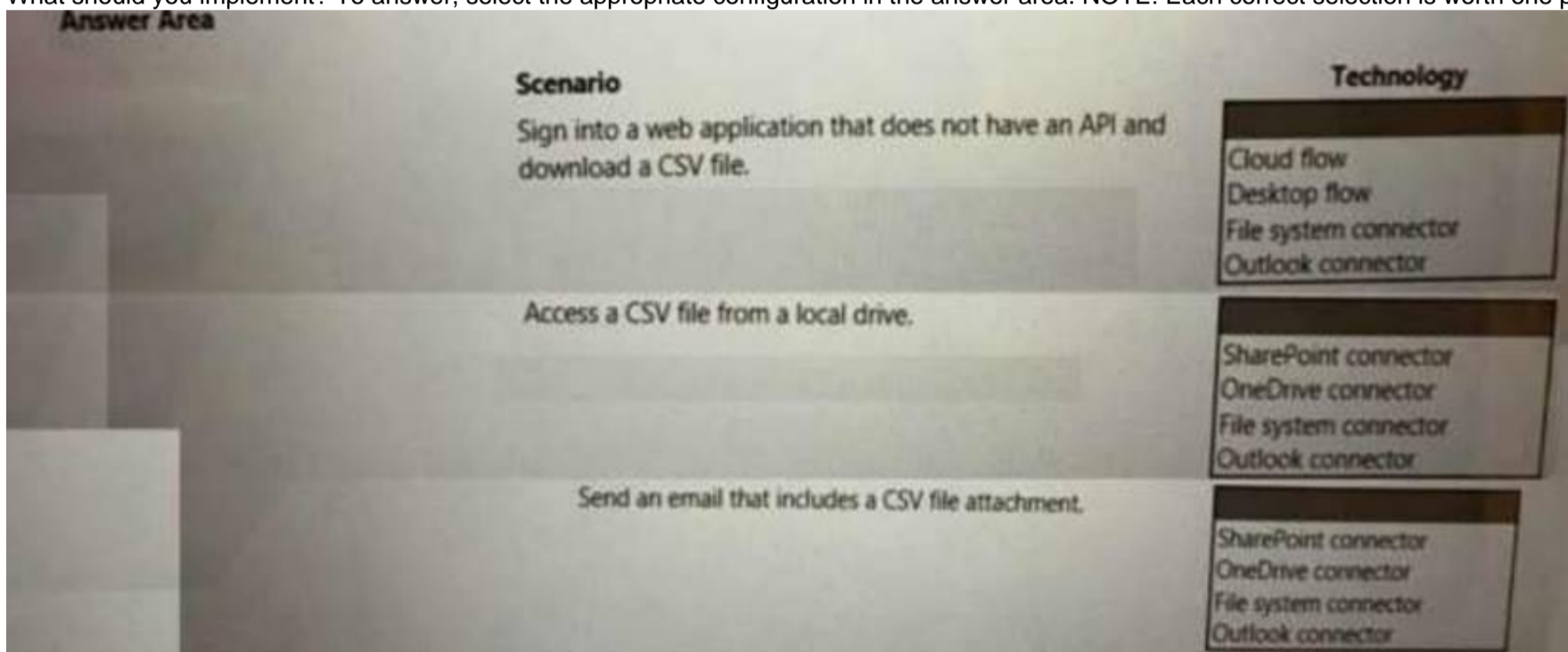

Solution:

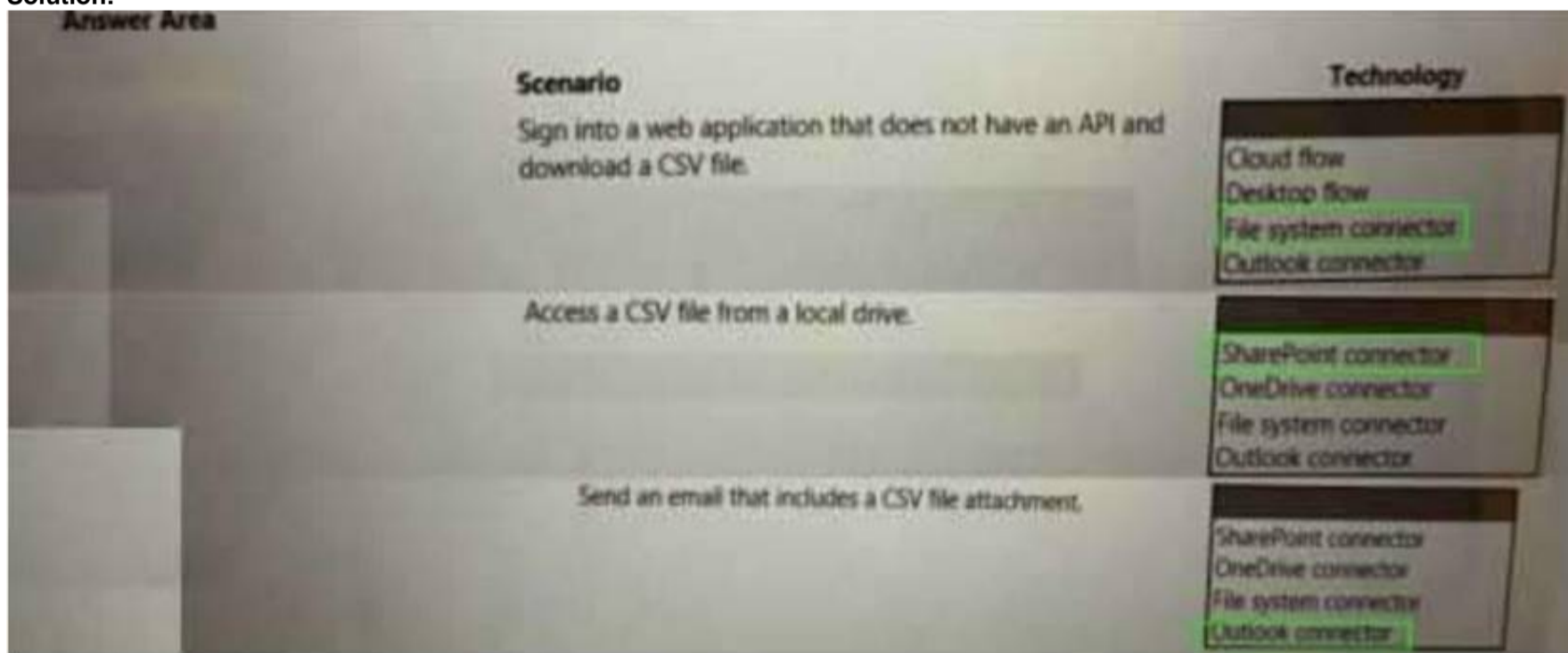

Does this meet the goal?

- A. Yes
- B. No

Answer: A

NEW QUESTION 19

- (Exam Topic 3)

You are developing a solution for a medical practice. The solution must use an artificial intelligence (AI) model to evaluate medical X-ray images and detect broken bones.

You need to create the AI model for the solution. Solution: Use Azure machine learning to create the model. Does the solution meet the goal?

- A. Yes
- B. No

Answer: B

NEW QUESTION 20

- (Exam Topic 3)

You are designing automation processes for a company.

You need to select the appropriate action for each automation scenario.

Which actions should you perform? To answer, select the appropriate options in the answer area. NOTE: Each correct selection is worth one point.

Requirement	Action
Automate keyboard input and mouse movements for a product ordering website that does not have an API.	<input type="checkbox"/> Add an HTTP trigger. <input type="checkbox"/> Create a custom connector. <input type="checkbox"/> Create a desktop flow.
Automate a process for a desktop application that provides an API with authenticated access.	<input type="checkbox"/> Create and run a dataflow. <input type="checkbox"/> Create a custom connector. <input type="checkbox"/> Create and run a Dataverse view. <input type="checkbox"/> Create a desktop flow.
Automate keyboard input and mouse movements for a desktop application.	<input type="checkbox"/> Create a custom connector. <input type="checkbox"/> Create a cloud flow. <input type="checkbox"/> Create a desktop flow.

Solution:

Requirement	Action
Automate keyboard input and mouse movements for a product ordering website that does not have an API.	<input checked="" type="checkbox"/> Add an HTTP trigger. <input checked="" type="checkbox"/> Create a custom connector. <input type="checkbox"/> Create a desktop flow.
Automate a process for a desktop application that provides an API with authenticated access.	<input checked="" type="checkbox"/> Create and run a dataflow. <input checked="" type="checkbox"/> Create a custom connector. <input type="checkbox"/> Create and run a Dataverse view. <input type="checkbox"/> Create a desktop flow.
Automate keyboard input and mouse movements for a desktop application.	<input type="checkbox"/> Create a custom connector. <input checked="" type="checkbox"/> Create a cloud flow. <input type="checkbox"/> Create a desktop flow.

Does this meet the goal?

- A. Yes
- B. No

Answer: A

NEW QUESTION 21

.....

Thank You for Trying Our Product

We offer two products:

1st - We have Practice Tests Software with Actual Exam Questions

2nd - Questions and Answers in PDF Format

PL-500 Practice Exam Features:

- * PL-500 Questions and Answers Updated Frequently
- * PL-500 Practice Questions Verified by Expert Senior Certified Staff
- * PL-500 Most Realistic Questions that Guarantee you a Pass on Your First Try
- * PL-500 Practice Test Questions in Multiple Choice Formats and Updates for 1 Year

100% Actual & Verified — Instant Download, Please Click
[Order The PL-500 Practice Test Here](#)