

# Microsoft

## Exam Questions MS-102

Microsoft 365 Administrator Exam



**NEW QUESTION 1**

- (Topic 6)

You have a Microsoft 365 E5 subscription.

You plan to implement Microsoft 365 compliance policies to meet the following requirements:

? Identify documents that are stored in Microsoft Teams and SharePoint Online that contain Personally Identifiable Information (PII).

? Report on shared documents that contain PII.

What should you create?

- A. an alert policy
- B. a data loss prevention (DLP) policy
- C. a retention policy
- D. a Microsoft Cloud App Security policy

**Answer: B**

**Explanation:**

Reference:

<https://docs.microsoft.com/en-us/microsoft-365/compliance/dlp-learn-about-dlp?view=o365-worldwide>

**NEW QUESTION 2**

- (Topic 6)

You have a Microsoft 365 E5 subscription.

You define a retention label that has the following settings:

- Retention period 7 years
- Start the retention period based on: When items were created

You need to prevent the removal of the label once the label is applied to an item. What should you select in the retention label settings?

- A. Retain items even if users delete
- B. Mark items as a record
- C. Mark items as a regulatory record
- D. Retain items forever

**Answer: B**

**NEW QUESTION 3**

- (Topic 6)

You have a Microsoft 365 E5 subscription that contains the users shown in the following table.

Name	Role
User1	Reports Reader
User2	Exchange Administrator
User3	User Experience Success Manager

Which users can review the Adoption Score in the Microsoft 365 admin center?

- A. User1 only
- B. User2 only
- C. User1 and User2 only
- D. User1 and User3 only
- E. User1, User2, and User3

**Answer: E**

**NEW QUESTION 4**

DRAG DROP - (Topic 6)

You have a Microsoft 365 subscription.

You have the devices shown in the following table.

Name	TPM version	Operating system	BIOS/UEFI	BitLocker Drive Encryption (BitLocker)
Device1	TPM 1.2	Windows 10 Pro	BIOS	Enabled
Device2	TPM 2	Windows 10 Home	BIOS	Not applicable
Device3	TPM 2	Windows 8.1 Pro	UEFI	Enabled

You plan to join the devices to Azure Active Directory (Azure AD)

What should you do on each device to support Azure AD join? To answer, drag the appropriate actions to the collect devices. Each action may be used once, more than once, or not at all. You may need to drag the split bar between panes or scroll to view content.

NOTE: Each correct selection is worth one point.



**Solution:**



Does this meet the goal?

- A. Yes
- B. No

**Answer:** A

**NEW QUESTION 5**

- (Topic 6)

You have a Microsoft 365 subscription that uses Microsoft 365 Defender.

You need to compare your company's security configurations to Microsoft best practices and review improvement actions to increase the security posture. What should you use?

- A. Microsoft Secure Score
- B. Cloud discovery
- C. Exposure distribution
- D. Threat tracker
- E. Exposure score

**Answer:** A

**NEW QUESTION 6**

- (Topic 6)

Note: This question is part of a series of questions that present the same scenario. Each question in the series contains a unique solution that might meet the stated goals. Some question sets might have more than one correct solution, while others might not have a correct solution.

After you answer a question in this section, you will NOT be able to return to it as a result these questions will not appear in the review screen.

Your network contains an Active Directory forest. You deploy Microsoft 365.

You plan to implement directory synchronization.

You need to recommend a security solution for the synchronized identities. The solution must meet the following requirements:

- Users must be able to authenticate successfully to Microsoft 365 services if Active Directory becomes unavailable.
- User passwords must be 10 characters or more.

Solution: implement password hash synchronization and modify the password settings from the Default Domain Policy in Active Directory. Does this meet the goal?

- A. Yes
- B. No

**Answer:** A

**NEW QUESTION 7**

- (Topic 6)

Your network contains an on-premises Active Directory domain named contoso.com.

For all user accounts, the Logon Hours settings are configured to prevent sign-ins outside of business hours.

You plan to sync contoso.com to an Azure AD tenant.

You need to recommend a solution to ensure that the logon hour restrictions apply when synced users sign in to Azure AD.

What should you include in the recommendation?

- A. pass-through authentication
- B. conditional access policies
- C. password synchronization
- D. Azure AD Identity Protection policies

**Answer:** A

**Explanation:**

Reference:

<https://nickblog.azurewebsites.net/2016/10/17/azure-ad-pass-through-authentication/>

**NEW QUESTION 8**

- (Topic 6)

You enable the Azure AD Identity Protection weekly digest email. You create the users shown in the following table.

Name	Role
Admin1	Security reader
Admin2	User administrator
Admin3	Security administrator
Admin4	Compliance administrator

Which users will receive the weekly digest email automatically?

- A. Admin2, Admin3, and Admin4 only
- B. Admin1, Admin2, Admin3, and Admin4
- C. Admin2 and Admin3 only
- D. Admin3 only
- E. Admin1 and Admin3 only

**Answer:** E

**Explanation:**

By default, all Global Admins receive the email. Any newly created Global Admins, Security Readers or Security Administrators will automatically be added to the recipients list.

**NEW QUESTION 9**

- (Topic 6)

You have a Microsoft 365 tenant that contains a Windows 10 device. The device is onboarded to Microsoft Defender for Endpoint. From Microsoft Defender Security Center, you perform a security investigation. You need to run a PowerShell script on the device to collect forensic information. Which action should you select on the device page?

- A. Initiate Live Response Session
- B. Initiate Automated Investigation
- C. Collect investigation package
- D. Go hunt

**Answer:** A

**Explanation:**

Reference:

<https://docs.microsoft.com/en-us/microsoft-365/security/defender-endpoint/live-response?view=o365-worldwide>

**NEW QUESTION 10**

- (Topic 6)

You have the sensitivity labels shown in the following exhibit.

[Home](#) > sensitivity

**Labels**      Label policies      Auto-labeling(preview)

Sensitivity labels are used to classify email messages, documents, sites, and more. When a label is applied (automatically or by the user), the content or site is protected based on the settings you choose. For example, you can create labels that encrypt files, add content marking, and control user access to specific sites. [Learn more about sensitivity labels](#)

+ Create a label    Publish labels    Refresh

Name ↑	Order	Created by	Last modified
Label1	0-highest	Prvi	04/24/2020
- Label2	1	Prvi	04/24/2020
Label3	0-highest	Prvi	04/24/2020
Label4	0-highest	Prvi	04/24/2020
- Label5	5	Prvi	04/24/2020
Label6	0-highest	Prvi	04/24/2020

Which labels can users apply to content?

- A. Label3, Label4, and Label6 only
- B. Label1, Label2, Label3, Label4, Label5, and Label6
- C. Label1, Label2, and Label5 only
- D. Label1, Label3, Label4, and Label6 only

**Answer:** D

**Explanation:**

Reference:

<https://docs.microsoft.com/en-us/microsoft-365/compliance/sensitivity-labels?view=o365-worldwide>

**NEW QUESTION 11**

- (Topic 6)

You have a Microsoft 365 subscription that contains an Azure AD tenant named contoso.com. The tenant contains the users shown in the following table.

Name	Username	Type
User1	User1@contoso.com	Member
User2	User2@sub.contoso.com	Member
User3	User3@adatum.com	Member
User4	User4@outlook.com	Guest
User5	User5@gmail.com	Guest

You create and assign a data loss prevention (DLP) policy named Policy1. Policy1 is configured to prevent documents that contain Personally Identifiable Information (PII) from being emailed to users outside your organization.

To which users can User1 send documents that contain PII?

- A. User2only
- B. User2and User3only
- C. User2, User3, and User4 only
- D. User2, User3, User4, and User5

**Answer:** B

**NEW QUESTION 12**

- (Topic 6)

You have a Microsoft 365 subscription.

You need to receive a notification each time a user in the service desk department grants Full Access permissions for a user mailbox.

What should you configure?

- A. a data loss prevention (DLP) policy
- B. an alert policy
- C. an audit search
- D. an insider risk management policy

**Answer:** B

**NEW QUESTION 13**

HOTSPOT - (Topic 6)

Your company uses Microsoft Defender for Endpoint.

The devices onboarded to Microsoft Defender for Endpoint are shown in the following table.

Name	Device group
Device1	ATP1
Device2	ATP1
Device3	ATP2

The alerts visible in the Microsoft Defender for Endpoint alerts queue are shown in the following table.

Name	Device
Alert1	Device1
Alert2	Device2
Alert3	Device3

You create a suppression rule that has the following settings:

- Triggering IOC: Any IOC
- Action: Hide alert
- Suppression scope: Alerts on ATP1 device group

For each of the following statements, select Yes if the statement is true. Otherwise, select No. NOTE: Each correct selection is worth one point

**Answer Area**

Statements	Yes	No
After you create the suppression rule, Alert1 is visible in the alerts queue.	<input type="radio"/>	<input type="radio"/>
After you create the suppression rule, Alert3 is visible in the alerts queue.	<input type="radio"/>	<input type="radio"/>
After you create the suppression rule, a new alert triggered on Device2 is visible in the alerts queue.	<input type="radio"/>	<input type="radio"/>

**Solution:**

**Answer Area**

Statements	Yes	No
After you create the suppression rule, Alert1 is visible in the alerts queue.	<input checked="" type="radio"/>	<input type="radio"/>
After you create the suppression rule, Alert3 is visible in the alerts queue.	<input checked="" type="radio"/>	<input type="radio"/>
After you create the suppression rule, a new alert triggered on Device2 is visible in the alerts queue.	<input type="radio"/>	<input checked="" type="radio"/>

Does this meet the goal?

- A. Yes
- B. No

**Answer: A**

**NEW QUESTION 14**

DRAG DROP - (Topic 6)

DRAG DROP

You have a Microsoft 365 subscription.

In the Exchange admin center, you have a data loss prevention (DLP) policy named Policy1 that has the following configurations:

- ? Block emails that contain financial data.
- ? Display the following policy tip text: Message blocked.

From the Security & Compliance admin center, you create a DLP policy named Policy2 that has the following configurations:

- ? Use the following location: Exchange email.
- ? Display the following policy tip text: Message contains sensitive data.
- ? When a user sends an email, notify the user if the email contains health records.

What is the result of the DLP policies when the user sends an email? To answer, drag the appropriate results to the correct scenarios. Each result may be used once, more than once, or not at all. You may need to drag the split bar between panes or scroll to view content.

NOTE: Each correct selection is worth one point.

Results	Answer Area
The email will be blocked, and the user will receive the policy tip: Message blocked.	When the user sends an email that contains financial data and health records: <input type="text" value="Result"/>
The email will be blocked, and the user will receive the policy tip: Message contains sensitive data.	When the user sends an email that contains only financial data: <input type="text" value="Result"/>
The email will be allowed, and the user will receive the policy tip: Message blocked.	
The email will be allowed, and the user will receive the policy tip: Message contains sensitive data.	
The email will be allowed, and a message policy tip will NOT be displayed.	

**Solution:**

Box 1: The email will be blocked, and the user will receive the policy tip: Message blocked. If you've created DLP policies in the Exchange admin center, those policies will continue to work side by side with any policies for email that you create in the Security & Compliance Center. But note that rules created in the Exchange admin center take precedence. All Exchange mail flow rules are processed first, and then the DLP rules from the Security & Compliance Center are processed.

Box 2: The email will be allowed, and the user will receive the policy tip: Message contains sensitive data.

Does this meet the goal?

- A. Yes
- B. No

**Answer: A**

**NEW QUESTION 15**

HOTSPOT - (Topic 6)

You have a Microsoft 365 E5 subscription that contains a user named User1 and the administrators shown in the following table.

User1 reports that after sending 1,000 email messages in the morning, the user is blocked from sending additional emails. You need to identify the following:

- Which administrators can unblock User1
- What to configure to allow User1 to send at least 2,000 emails per day without being blocked

What should you identify? To answer, select the appropriate options in the answer area. NOTE: Each correct selection is worth one point.

**Answer Area**

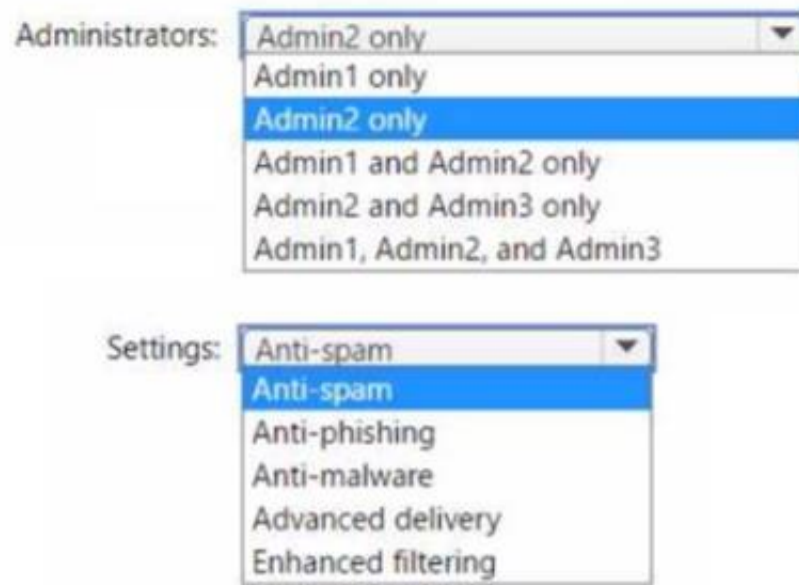

**Solution:**

**Answer Area**

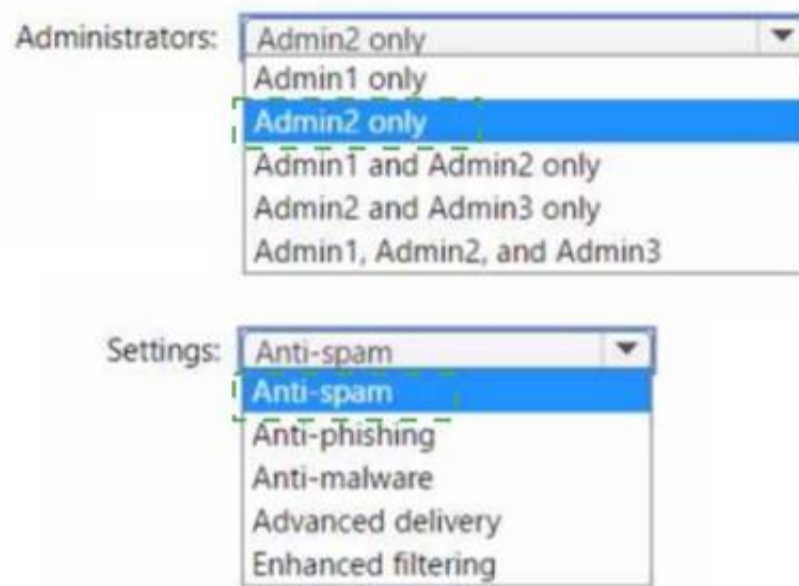

Does this meet the goal?

- A. Yes
- B. No

**Answer: A**

**NEW QUESTION 16**

- (Topic 6)

You have a Microsoft 365 subscription. You have a user named User1. You need to ensure that User1 can place a hold on all mailbox content. What permission should you assign to User1?

- A. the Information Protection administrator role from the Azure Active Directory admin center.
- B. the eDiscovery Manager role from the Microsoft 365 compliance center.
- C. the Compliance Management role from the Exchange admin center.
- D. the User management administrator role from the Microsoft 365 admin center.

**Answer: B**

**NEW QUESTION 17**

HOTSPOT - (Topic 6)

Your network contains an on-premises Active Directory domain named adatum.com that syncs to Azure AD by using the Azure AD Connect Express Settings. Password write back is disabled.

You create a user named User1 and enter Pass in the Password field as shown in the following exhibit.

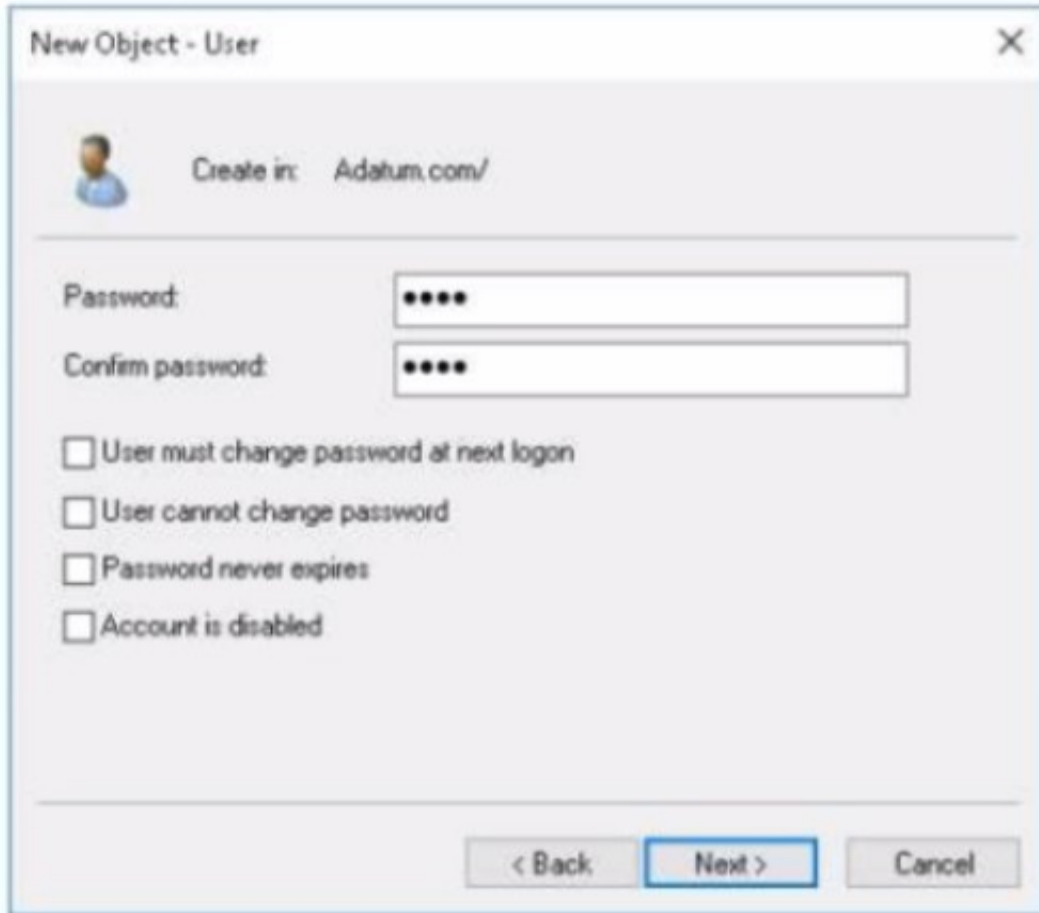

The Azure AD password policy is configured as shown in the following exhibit. Password policy Set the password policy for all users in your organization. Days before passwords expire 90 Days before a user is notified about 14 expiration You confirm that User1 is synced to Azure AD. For each of the following statements, select Yes if the statement is true. Otherwise, select No. NOTE: Each correct selection is worth one point.

**Answer Area**

Statements	Yes	No
User1 can sign in to Azure AD.	<input type="radio"/>	<input type="radio"/>
User1 can change the password immediately by using the My Apps portal.	<input type="radio"/>	<input type="radio"/>
From Azure AD, User1 must change the password every 90 days.	<input type="radio"/>	<input type="radio"/>

**Solution:**

**Answer Area**

Statements	Yes	No
User1 can sign in to Azure AD.	<input checked="" type="radio"/>	<input type="radio"/>
User1 can change the password immediately by using the My Apps portal.	<input type="radio"/>	<input checked="" type="radio"/>
From Azure AD, User1 must change the password every 90 days.	<input checked="" type="radio"/>	<input type="radio"/>

Does this meet the goal?

- A. Yes
- B. No

**Answer: A**

**NEW QUESTION 18**

HOTSPOT - (Topic 6)

You work at a company named Contoso, Ltd.

Contoso has a Microsoft 365 subscription that is configured to use the DNS domains shown in the following table.

Contoso purchases a company named Fabrikam, Inc.

Contoso plans to add the following domains to the Microsoft 365 subscription:

- fabrikam.com
- east.fabrikam.com
- west.contoso.com

You need to ensure that the devices in the new domains can register by using Autodiscover.

How many domains should you verify, and what is the minimum number of enterprise registration DNS records you should add? To answer, select the appropriate options in the answer area.

NOTE: Each correct selection is worth one point.



**Answer Area**



**Solution:**

**Answer Area**



Does this meet the goal?

- A. Yes
- B. No

**Answer: A**

**NEW QUESTION 19**

- (Topic 6)

You have a Microsoft 365 subscription.

You configure a new Azure AD enterprise application named App1. App1 requires that a user be assigned the Reports Reader role.

Which type of group should you use to assign the Reports Reader role and to access App1?

- A. a Microsoft 365 group that has assigned membership
- B. a Microsoft 365 group that has dynamic user membership
- C. a security group that has assigned membership
- D. a security group that has dynamic user membership

**Answer: C**

**Explanation:**

To grant permissions to assignees to manage users and group access for a specific enterprise app, go to that app in Azure AD and open in the Roles and Administrators list for that app. Select the new custom role and complete the user or group assignment. The assignees can manage users and group access only for the specific app.

Note: You can add the following types of groups:

Assigned groups - Manually add users or devices into a static group.

Dynamic groups (Requires Azure AD Premium) - Automatically add users or devices to user groups or device groups based on an expression you create.

Note:

Security groups

Security groups are used for granting access to Microsoft 365 resources, such as SharePoint. They can make administration easier because you need only administer the group rather than adding users to each resource individually.

Security groups can contain users or devices. Creating a security group for devices can be used with mobile device management services, such as Intune.

Security groups can be configured for dynamic membership in Azure Active Directory, allowing group members or devices to be added or removed automatically based on user attributes such as department, location, or title; or device attributes such as operating system version.

Security groups can be added to a team.

Microsoft 365 Groups can't be members of security groups. Microsoft 365 Groups

Microsoft 365 Groups are used for collaboration between users, both inside and outside your company. With each Microsoft 365 Group, members get a group email and shared workspace for conversations, files, and calendar events, Stream, and a Planner.

Reference:

<https://learn.microsoft.com/en-us/azure/active-directory/roles/custom-enterprise-apps> <https://learn.microsoft.com/en-us/microsoft-365/admin/create-groups/compare-groups?> <https://learn.microsoft.com/en-us/mem/intune/apps/apps-deploy>

**NEW QUESTION 20**

HOTSPOT - (Topic 6)

You have a Microsoft 365 subscription that contains the administrative units shown in the following table.

Name	Members
AU1	Group1, User2
AU2	Group2, User3, User4

The groups contain the members shown in the following table.

Name	Members
Group1	User1
Group2	User2, User4

The users are assigned the roles shown in the following table.

Name	Role	Scope
User1	None	Not applicable
User2	Password Administrator	AU1
User3	License Administrator	Organization
User4	None	Not applicable

For each of the following statements, select Yes if the statement is true. Otherwise, select No.  
 NOTE; Each correct selection is worth one point.

**Answer Area**

Statements	Yes	No
User2 can reset the password of User1.	<input type="radio"/>	<input type="radio"/>
User2 can reset the password of User4.	<input type="radio"/>	<input type="radio"/>
User3 can assign licenses to User1.	<input type="radio"/>	<input type="radio"/>

**Solution:**

**Answer Area**

Statements	Yes	No
User2 can reset the password of User1.	<input checked="" type="radio"/>	<input type="radio"/>
User2 can reset the password of User4.	<input type="radio"/>	<input checked="" type="radio"/>
User3 can assign licenses to User1.	<input checked="" type="radio"/>	<input type="radio"/>

Does this meet the goal?

- A. Yes
- B. No

**Answer:** A

**NEW QUESTION 21**

HOTSPOT - (Topic 6)  
 HOTSPOT

Your company uses a legacy on-premises LDAP directory that contains 100 users. The company purchases a Microsoft 365 subscription. You need to import the 100 users into Microsoft 365 by using the Microsoft 365 admin center.

Which type of file should you use and which properties are required? To answer, select the appropriate options in the answer area.

NOTE: Each correct selection is worth one point.

**Answer Area**

File type to use:

▼

CSV  
 JSON  
 PST  
 XML

Required properties for each user:

▼

Display Name and Department  
 First Name and Last Name  
 User Name and Department  
 User Name and Display Name

**Solution:**

Box 1: CSV

Add multiple users in the Microsoft 365 admin center

? Sign in to Microsoft 365 with your work or school account.

? In the admin center, choose Users > Active users.

? Select Add multiple users.

? On the Import multiple users panel, you can optionally download a sample CSV file with or without sample data filled in.

? Etc.

Note: More information about how to add users to Microsoft 365 Not sure what CSV format is?

A CSV file is a file with comma separated values. You can create or edit a file like this with any text editor or spreadsheet program, such as Excel.

Box 2: User Name and Display Name

What if I don't have all the information required for each user? The user name and display name are required, and you cannot add a new user without this information. If you don't have some of the other information, such as the fax, you can use a space plus a comma to indicate that the field should remain blank.

Does this meet the goal?

- A. Yes
- B. No

**Answer: A**

**NEW QUESTION 22**

HOTSPOT - (Topic 1)

You need to meet the Intune requirements for the Windows 10 devices.

What should you do? To answer, select the appropriate options in the answer area.

NOTE: Each correct selection is worth one point.

Settings to configure in Azure AD:

▼
Device settings
Mobility (MDM and MAM)
Organizational relationships
User settings

Settings to configure in Intune:

▼
Device compliance
Device configuration
Device enrollment
Mobile Device Management Authority

**Solution:**

References:

<https://docs.microsoft.com/en-us/intune/windows-enroll>

Does this meet the goal?

- A. Yes
- B. No

**Answer: A**

**NEW QUESTION 23**

- (Topic 6)

You have a Microsoft 365 subscription that contains the users shown in the following table.

Name	Microsoft 365 admin role	Microsoft Exchange Online admin role
User1	Global Administrator	None
User2	Exchange Administrator	None
User3	Service Support Administrator	None
User4	None	Organization Management

You plan to use Exchange Online to manage email for a DNS domain. An administrator adds the DNS domain to the subscription. The DNS domain has a status of Incomplete setup.

You need to identify which user can complete the setup of the DNS domain. The solution must use the principle of least privilege.

Which user should you identify?

- A. User1
- B. User2
- C. User3
- D. User4

Answer: A

**NEW QUESTION 24**

- (Topic 6)

You have a Microsoft 365 E5 subscription that contains the groups shown in the following exhibit.

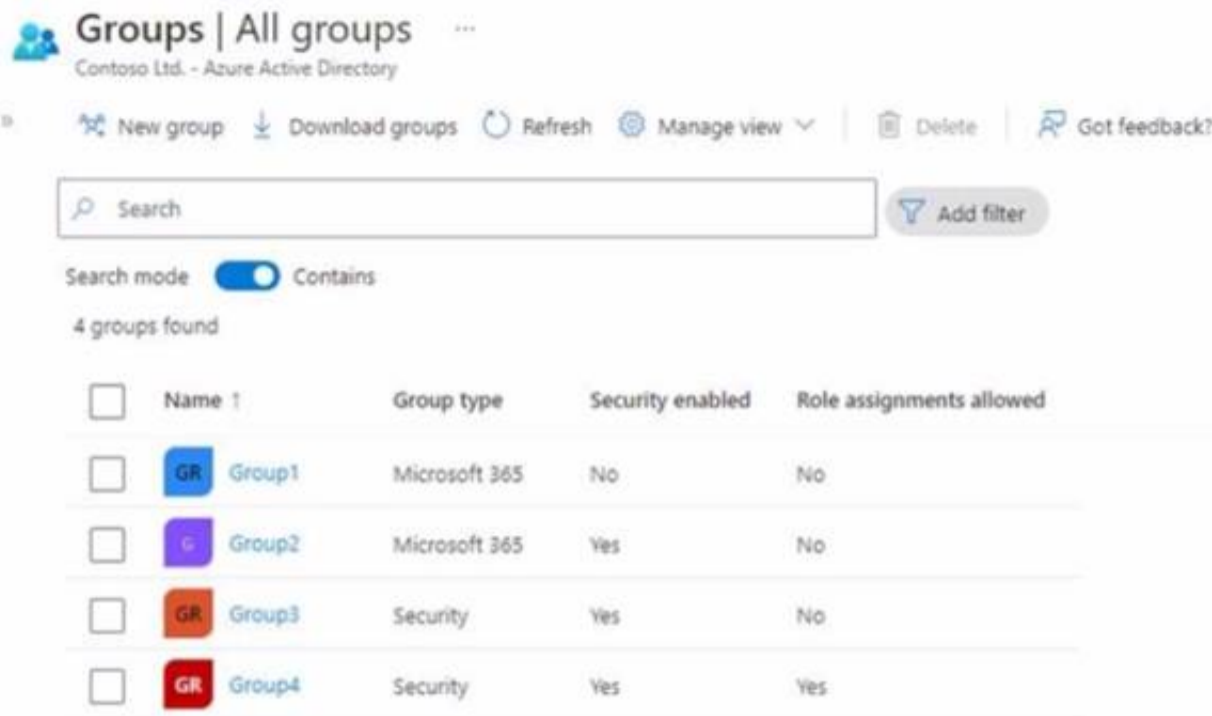

To which groups can you assign Microsoft 365 E5 licenses?

- A. Group1 and Group2 only
- B. Group2 and Group3 only
- C. Group3 and Group4 only
- D. Group 1, Group2, and Group3 only
- E. Group2, Group3, and Group4 only

Answer: C

**NEW QUESTION 25**

- (Topic 6)

Your company has an Azure AD tenant named contoso.com that includes the users shown in the following table.

Name	Usage location	Membership
User1	United States	Group1, Group2
User2	Not set	Group2
User3	Not set	Group1
User4	Canada	Group1

Group2 is a member of Group1.

You assign an Office 365 Enterprise E3 license to Group1. How many Office 365 E3 licenses are assigned?

- A. 1
- B. 2
- C. 3
- D. 4

Answer: C

**NEW QUESTION 26**

- (Topic 6)

Note: This question is part of a series of questions that present the same scenario.

Each question in the series contains a unique solution that might meet the stated goals. Some question sets might have more than one correct solution, while others might not have a correct solution.

After you answer a question in this section, you will NOT be able to return to it. As a result, these questions will not appear in the review screen.

Your network contains an on-premises Active Directory domain named contoso.com. The domain contains the users shown in the following table.

Name	UPN suffix
User1	Contoso.com
User2	Fabrikam.com

The domain syncs to an Azure AD tenant named contoso.com as shown in the exhibit. (Click the Exhibit tab.)

## PROVISION FROM ACTIVE DIRECTORY



### Azure AD Connect cloud provisioning

This feature allows you to manage provisioning from the cloud.

[Manage provisioning \(Preview\)](#)

### Azure AD Connect sync

Sync Status	Enabled
Last Sync	Less than 1 hour ago
Password Hash Sync	Enabled

## USER SIGN-IN



Federation	Disabled	0 domains
Seamless single sign-on	Enabled	1 domain
Pass-through authentication	Enabled	2 agents

User2 fails to authenticate to Azure AD when signing in as user2@fabrikam.com.

You need to ensure that User2 can access the resources in Azure AD.

Solution: From the on-premises Active Directory domain, you set the UPN suffix for User2 to @contoso.com. You instruct User2 to sign in as user2@contoso.com. Does this meet the goal?

- A. Yes
- B. No

**Answer:** A

### Explanation:

The on-premises Active Directory domain is named contoso.com. You can enable users to sign on using a different UPN (different domain), by adding the domain to Microsoft 365 as a custom domain. Alternatively, you can configure the user account to use the existing domain (contoso.com).

### NEW QUESTION 27

HOTSPOT - (Topic 6)

You have a Microsoft 365 E5 subscription that contains the users shown in the following table.

Each user has an Android device with the Microsoft Authenticator app installed and has set up phone sign-in.

The subscription has the following Conditional Access policy:

- Name: Policy1
- Assignments
  - o Users and groups: Group1, Group2
  - o Cloud apps or actions: All cloud apps
- Access controls
  - o Grant Require multi-factor authentication
- Enable policy: On

From Microsoft Authenticator settings for the subscription, the Enable and Target settings are configured as shown in the exhibit. (Click the Exhibit tab.)

## Microsoft Authenticator settings ...



**i** Number Matching will begin to be enabled for all users of the Microsoft Authenticator app starting 27th of February 2023. [Learn more](#)

The Microsoft Authenticator app is a flagship authentication method, usable in passwordless or simple push notification approval modes. The app is free to download and use on Android/iOS mobile devices. [Learn more](#).

**Enable and Target** Configure

Enable

**Include** Exclude

Target  All users  Select groups

Add groups

Name	Type	Registration	Authentication mode
Group1	Group	Optional	Passwordless
Group2	Group	Optional	Passwordless

For each of the following statements, select Yes if the statement is true. Otherwise, select No.  
 NOTE: Each correct selection is worth one point.

**Answer Area**

Statements	Yes	No
<input type="radio"/> User1 can sign in by using number matching in the Microsoft Authenticator app.	<input type="radio"/>	<input type="radio"/>
<input type="radio"/> User2 can sign in by using a username and password.	<input type="radio"/>	<input type="radio"/>
<input type="radio"/> User3 can sign in by using number matching in the Microsoft Authenticator app.	<input type="radio"/>	<input type="radio"/>

**Solution:**

**Answer Area**

Statements	Yes	No
<input type="radio"/> User1 can sign in by using number matching in the Microsoft Authenticator app.	<input checked="" type="radio"/>	<input type="radio"/>
<input type="radio"/> User2 can sign in by using a username and password.	<input type="radio"/>	<input checked="" type="radio"/>
<input type="radio"/> User3 can sign in by using number matching in the Microsoft Authenticator app.	<input type="radio"/>	<input checked="" type="radio"/>

Does this meet the goal?

- A. Yes
- B. No

**Answer: A**

**NEW QUESTION 28**

HOTSPOT - (Topic 6)

You use Microsoft Defender for Endpoint.

You have the Microsoft Defender for Endpoint device groups shown in the following table

Name	Rank	Members
Group1	1	Operating system in Windows 10
Group2	2	Name ends with London
Group3	3	Operating system in Windows Server 2016
Ungrouped machines (default)	Last	<i>Not applicable</i>

You plan to onboard computers to Microsoft Defender for Endpoint as shown in the following table.

**Answer Area**



**Solution:**

**Answer Area**

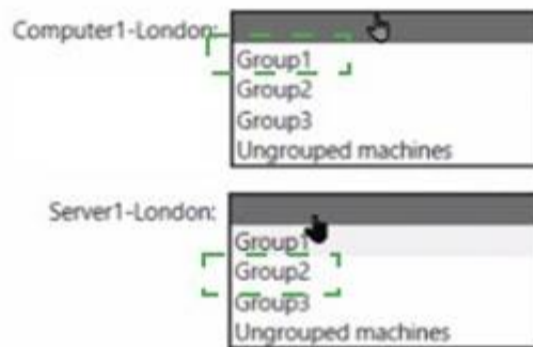

Does this meet the goal?

- A. Yes
- B. No

**Answer: A**

**NEW QUESTION 29**

- (Topic 6)

You have a Microsoft 365 E5 subscription that is linked to a Microsoft Entra tenant named contoso.com. You purchase 100 Microsoft 365 Business Voice add-on licenses. You need to ensure that the members of a group named Voice are assigned a Microsoft 365 Business Voice add-on license automatically. What should you do?

- A. From the Microsoft 365 admin center, modify the settings of the Voice group.
- B. From the Licenses page of the Microsoft 365 admin center, assign the licenses.
- C. From the Microsoft Entra admin center, modify the settings of the Voice group.

**Answer: C**

**NEW QUESTION 30**

- (Topic 6)

You have a Microsoft 365 subscription. You create a retention label named Retention1 as shown in the following exhibit.

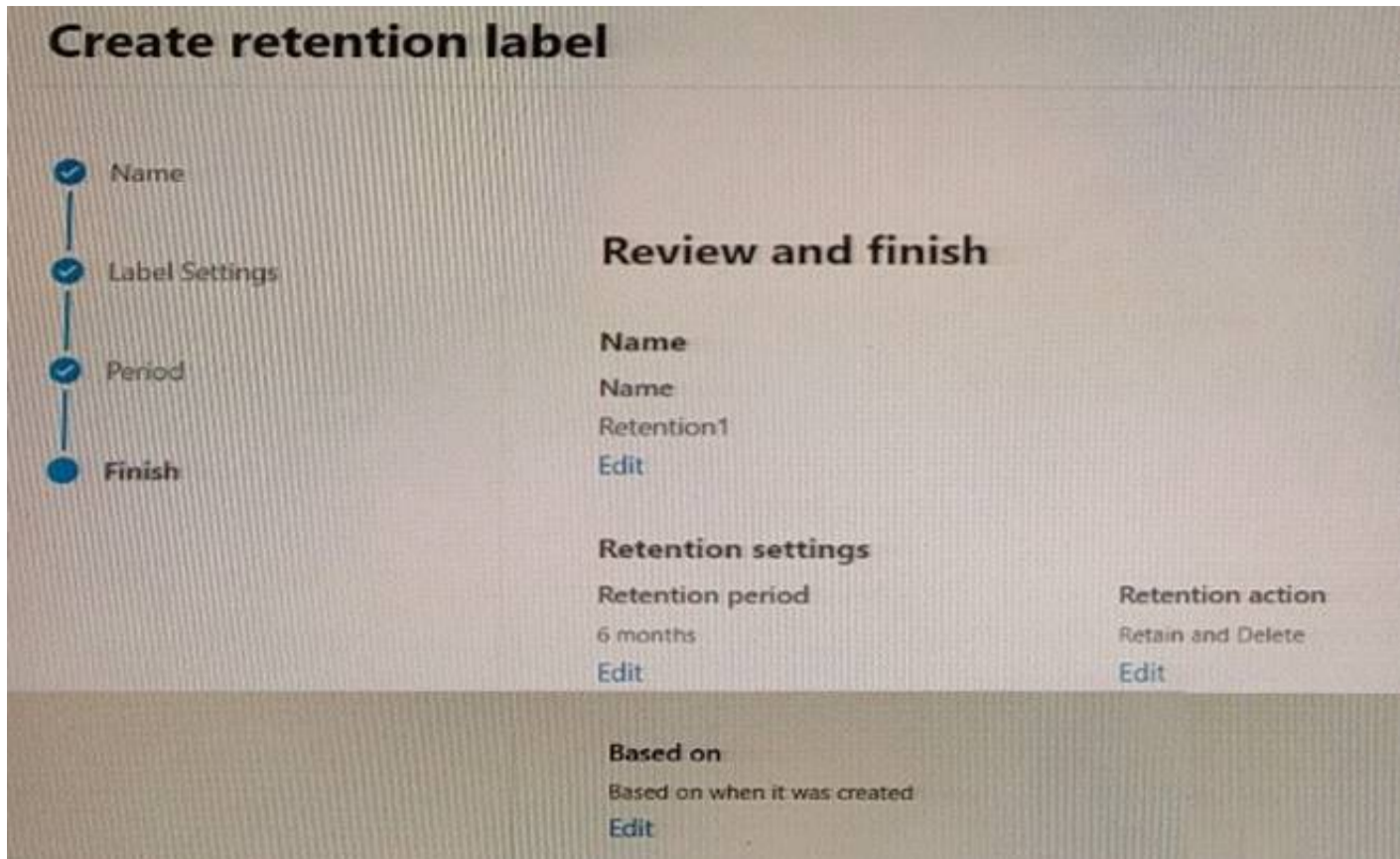

You apply Retention1 to all the Microsoft OneDrive content.  
 On January 1, 2020, a user stores a file named File1 in OneDrive.  
 On January 10, 2020, the user modifies File1. On February 1, 2020, the user deletes File1.  
 When will File1 be removed permanently and unrecoverable from OneDrive?

- A. February 1, 2020
- B. July 1, 2020
- C. July 10, 2020
- D. August 1, 2020

Answer: B

**NEW QUESTION 31**

.....



## **Thank You for Trying Our Product**

### **We offer two products:**

1st - We have Practice Tests Software with Actual Exam Questions

2nd - Questions and Answers in PDF Format

### **MS-102 Practice Exam Features:**

- \* MS-102 Questions and Answers Updated Frequently
- \* MS-102 Practice Questions Verified by Expert Senior Certified Staff
- \* MS-102 Most Realistic Questions that Guarantee you a Pass on Your First Try
- \* MS-102 Practice Test Questions in Multiple Choice Formats and Updates for 1 Year

**100% Actual & Verified — Instant Download, Please Click**  
[Order The MS-102 Practice Test Here](#)