

Microsoft

Exam Questions AZ-140

Configuring and Operating Windows Virtual Desktop on Microsoft Azure



NEW QUESTION 1

- (Topic 3)

You have a Azure Virtual Desktop deployment.

In Azure Advisor, you discover the following recommendation related to Azure Virtual Desktop:

- Impact Medium
- Description: No validation environment enabled
- Potential Benefit Ensure business continuity through AVD service deployments
- Impacted Resource:1 Host Pool

What can you validate by implementing the recommendations?

- A. Capacity requirements of the session hosts
- B. Security settings of Azure Virtual Desktop
- C. Preview features for Azure Virtual Desktop
- D. Azure Site Recovery failover of the session hosts

Answer: D

Explanation:

Validation environments are used to test and validate Azure Virtual Desktop deployments before they are made available to users. This can include testing the capacity of the session hosts, the performance of the deployment, and the configuration of security settings. By implementing a validation environment, you can ensure that the Azure Virtual Desktop deployment is working correctly and that there are no issues that could impact business continuity. This can help to ensure a smooth user experience and minimize downtime.

NEW QUESTION 2

DRAG DROP - (Topic 3)

You have a Windows Virtual Desktop host pool named Pool1. Pool1 contains session hosts that use FSLogix profile containers hosted in Azure NetApp Files volumes.

You need to back up profile files by using snapshots.

Which three actions should you perform in sequence? To answer, move the appropriate

| Actions | Answer Area |
|--|-------------|
| Create an Azure NetApp account. | |
| Register the NetApp Resource Provider. | ⬅️ |
| Register the Azure NetApp snapshot policy feature. | ➡️ |
| Create a snapshot policy. | |
| Apply a snapshot policy to a volume. | ⬆️ |

Solution:

| Actions | Answer Area |
|--|-------------|
| Create an Azure NetApp account. | |
| Register the NetApp Resource Provider. | |
| Register the Azure NetApp snapshot policy feature. | ⬅️ |
| Create a snapshot policy. | ⬆️ |
| Apply a snapshot policy to a volume. | ⬇️ |

Does this meet the goal?

- A. Yes
- B. No

Answer: A

NEW QUESTION 3

- (Topic 3)

You deploy a Windows Virtual Desktop host pool named Pool1.

You have an Azure Storage account named store1 that stores FSLogix profile containers in a share named profiles.

You need to configure the path to the storage containers for the session hosts. Which path should you use?

- A. \\store1.blob.core.windows.net\profiles
- B. https://store1.file.core.windows.net/profiles
- C. \\store1.file.core.windows.net\profiles
- D. https://store1.blob.core.windows.net/profiles

Answer: C

Explanation:

<https://docs.microsoft.com/en-us/azure/virtual-desktop/store-fslogix-profile> Azure offers multiple storage solutions that you can use to store your FSLogix profile container. We recommend storing FSLogix profile containers on Azure Files for most of our customers.

NEW QUESTION 4

- (Topic 3)

You have an Azure Virtual Desktop deployment that contains the resources shown in the following table.

| Name | Description |
|-----------|--|
| HostPool1 | Personal host pool that contains five session hosts |
| VNET1 | Azure virtual network with a subnet named Subnet1 |
| Subnet1 | Virtual network subnet to which the five session hosts are connected |

You need to enable just-in-time (JIT) VM access for all the session hosts. What should you do first?

- A. Deploy Azure Bastion to VNET1.
- B. Assign network security groups (NSGs) to the network interfaces of the five session hosts.
- C. Configure Access control (IAM) for HostPool1.
- D. Assign a network security group (NSG) to Subnet1.

Answer: B

NEW QUESTION 5

- (Topic 3)

You have a Azure Virtual Desktop host pool that contains live session hosts. The session hosts run Windows 10 Enterprise multi-session.

You need to prevent users from accessing the internet from Azure Virtual Desktop sessions. The session hosts must be allowed to access all the required Microsoft services.

Solution: You configure the RDP Properties of the host pool. Does This meet the goal?

- A. Yes
- B. No

Answer: B

NEW QUESTION 6

HOTSPOT - (Topic 3)

You have an Azure Virtual Desktop Deployment that contains a workspace named Workspace1 and a user named User1. Workspace1 contains a Desktop application group named Pool1Desktop.

At 09:00, you create a conditional access policy that has the following settings:

? Assignments:

- Users and groups: User1
- Cloud apps or actions: Azure Virtual Desktop
- Conditions: 0 conditions selected

? Access controls

- Grant: Grant access, Require multi-factor authentication
- Sessions: Sign-in frequency 1 hour

User1 performs the actions shown in the following table.

For each of the following statements, select Yes if the statement is true. Otherwise, select No.

NOTE: Each correct selection is worth one point.

| Statements | Yes | No |
|---|-----------------------|-----------------------|
| User1 is prompted for multi-factor authentication (MFA) at 09:10. | <input type="radio"/> | <input type="radio"/> |
| User1 is prompted for multi-factor authentication (MFA) at 10:20. | <input type="radio"/> | <input type="radio"/> |
| User1 is prompted for multi-factor authentication (MFA) at 13:50. | <input type="radio"/> | <input type="radio"/> |

Solution:

| Statements | Yes | No |
|---|----------------------------------|----------------------------------|
| User1 is prompted for multi-factor authentication (MFA) at 09:10. | <input checked="" type="radio"/> | <input type="radio"/> |
| User1 is prompted for multi-factor authentication (MFA) at 10:20. | <input type="radio"/> | <input checked="" type="radio"/> |
| User1 is prompted for multi-factor authentication (MFA) at 13:50. | <input checked="" type="radio"/> | <input type="radio"/> |

Does this meet the goal?

- A. Yes
- B. No

Answer: A

NEW QUESTION 7

- (Topic 3)

You have an Azure Virtual Desktop host pool named HostPool1 that contains 20 session hosts. You create a new scaling plan that has the Ramp-up settings shown in the following exhibit.

Add a schedule

General
 Ramp-up
 Peak hours
 Ramp-down
 Off-peak hours

Repeats on: Mon, Tue, Wed, Thu, Fri

Time zone: (UTC-06:00) Central Time (US & Canada)

Start time (24 hour system) * ⓘ: 08:00

Load balancing algorithm ⓘ: Breadth-first

Minimum percentage of hosts (%) * ⓘ: 20

Capacity threshold (%) * ⓘ: 60

Use the drop-down menus to select the answer choice that completes each statement based on the information presented in the graphic. NOTE: Each correct selection is worth one point.

Starting at 08:00, [answer choice] session hosts will start for ramp-up.

| |
|----|
| 2 |
| 4 |
| 16 |
| 20 |

New user sessions will be distributed [answer choice].

| |
|--|
| evenly across all available session hosts |
| to the session host that has the lowest CPU usage |
| to the session host with the most connections that has not reached the limit |

Solution:

Starting at 08:00, [answer choice] session hosts will start for ramp-up.

| |
|----|
| 2 |
| 4 |
| 16 |
| 20 |

New user sessions will be distributed [answer choice].

| |
|--|
| evenly across all available session hosts |
| to the session host that has the lowest CPU usage |
| to the session host with the most connections that has not reached the limit |

Does this meet the goal?

- A. Yes
- B. No

Answer: A

NEW QUESTION 8

- (Topic 3)

You have a Azure Virtual Desktop host pool named Pool1 that contains three session hosts. The session hosts are configured to use FSLogtx profile containers. You need to configure Cloud Cache on the session hosts. What should you do?

- A. Remove VHDlocations entries from the Windows registry.
- B. Configure FSLogtx Office Container.
- C. Add VHDlocations entries to the Windows registry.
- D. Uninstall the FSLogix agent

Answer: A

Explanation:

Reference:
<https://docs.microsoft.com/en-us/fslogix/configure-cloud-cache-tutorial>

NEW QUESTION 9

HOTSPOT - (Topic 3)

Your network contains an on-premises Active Directory domain that syncs to an Azure Active Directory (Azure AD) tenant. The domain contains the users shown in

the following table.

| Name | Role | Member of |
|-------|---|-----------|
| User1 | Desktop Virtualization Workspace Reader | Group1 |
| User2 | Desktop Virtualization Application Group Reader | Group2 |

You have a Windows Virtual Desktop deployment that contains the application groups shown in the following table.

| Name | Application | Assignment |
|-----------|----------------------|----------------|
| AppGroup1 | Microsoft Word | Group1 |
| AppGroup2 | Microsoft Excel | Group2 |
| AppGroup3 | Microsoft PowerPoint | Group1, Group2 |

You have the workspaces shown in the following table.

| Name | Application group |
|------------|-------------------|
| Workspace1 | AppGroup1 |
| Workspace2 | AppGroup2 |

For each of the following statements, select Yes if the statement is true. Otherwise, select No.

NOTE: Each correct selection is worth one point.

Answer Area

| Statements | Yes | No |
|---|-----------------------|-----------------------|
| User1 has PowerPoint listed in the Remote Desktop client. | <input type="radio"/> | <input type="radio"/> |
| User1 has Word listed in the Remote Desktop client. | <input type="radio"/> | <input type="radio"/> |
| User2 has PowerPoint listed in the Remote Desktop client. | <input type="radio"/> | <input type="radio"/> |

Solution:

Answer Area

| Statements | Yes | No |
|---|----------------------------------|----------------------------------|
| User1 has PowerPoint listed in the Remote Desktop client. | <input type="radio"/> | <input checked="" type="radio"/> |
| User1 has Word listed in the Remote Desktop client. | <input checked="" type="radio"/> | <input type="radio"/> |
| User2 has PowerPoint listed in the Remote Desktop client. | <input type="radio"/> | <input checked="" type="radio"/> |

Does this meet the goal?

- A. Yes
- B. No

Answer: A

NEW QUESTION 10

- (Topic 3)

You have an Azure Virtual Desktop deployment that uses Azure Active Directory Domain Services (Azure AD DS). You have the following host pool:

- Name: Pool1
- Type: Personal
- Number of session hosts: 5

You plan to deploy two new session hosts to Pool1. What should you do before you deploy the session hosts?

- A. Create a scaling plan.
- B. Precreate a computer account in Azure AD DS.
- C. Increase the maximum session limit.
- D. Create a registration key.

Answer: B

Explanation:

This is done by using the Add-AzDomainComputer cmdlet in PowerShell. After the computer accounts have been created, the new session hosts can be deployed.

For more information, please refer to the following Microsoft

documentation: <https://docs.microsoft.com/en-us/azure/virtual-desktop/create-session-host-pools#precreate-computer-accounts-in-azure-ad-ds>.

NEW QUESTION 11

- (Topic 3)

You have an Azure Virtual Desktop host pool. The pool contains session hosts that run Windows 10 Enterprise multi-session.

You connect to a Remote Desktop session on Pool1 and discover an issue with the frequency of screen updates.

You need to identify whether the issue relates to insufficient server, network, or client resources. The solution must minimize how long it takes to identify the resource type.

What should you do?

- A. From within the current session, use the Azure Virtual Desktop Experience Estimator.
- B. From Azure Cloud Shell, run the Get-AzOperationalInsightsWorkspaceUsage cmdlet and specify the DefaultProfile parameter.
- C. From Azure Cloud Shell, run the Get-AzWvdUserSession cmdlet and specify the UserSessionId parameter.
- D. From within the current session, use Performance Monitor to display the values of all the RemoteFX Graphics(*)\Frames Skipped/Second counters.

Answer: D

Explanation:

Reference:

<https://docs.microsoft.com/en-us/azure/virtual-desktop/remotefx-graphics-performance-counters>

NEW QUESTION 12

HOTSPOT - (Topic 3)

You plan to deploy two Azure file shares named Share1 and Share2 that will be used with Azure Virtual Desktop. Share1 will contain at least 100 GB of data and must be stored on SSDs. Share2 must be able to switch between Transaction optimized and Cool storage tiers and must be stored on HDDs.

You need to recommend which type of storage accounts to use for the shares. The solution must minimize costs.

What should you recommend for each share? To answer, select the appropriate options in the answer area.

NOTE: Each correct selection is worth one point.

Answer Area

Share1:

Share2:

Solution:

<https://learn.microsoft.com/en-us/azure/storage/files/storage-how-to-create-file-share?tabs=azure-portal>

Does this meet the goal?

- A. Yes
- B. No

Answer: A

NEW QUESTION 13

HOTSPOT - (Topic 3)

You have a hybrid Azure Active Directory (Azure AD) tenant named contoso.com that contains the users shown in the following table.

| Name | Member of |
|-------|----------------|
| User1 | Group1 |
| User2 | Group2 |
| User3 | Group1, Group3 |

You have an Azure Virtual Desktop host pool. All the session hosts have a folder named C:\Folder1.

You create an FSLogix Application Masking rule as shown in the following exhibit.

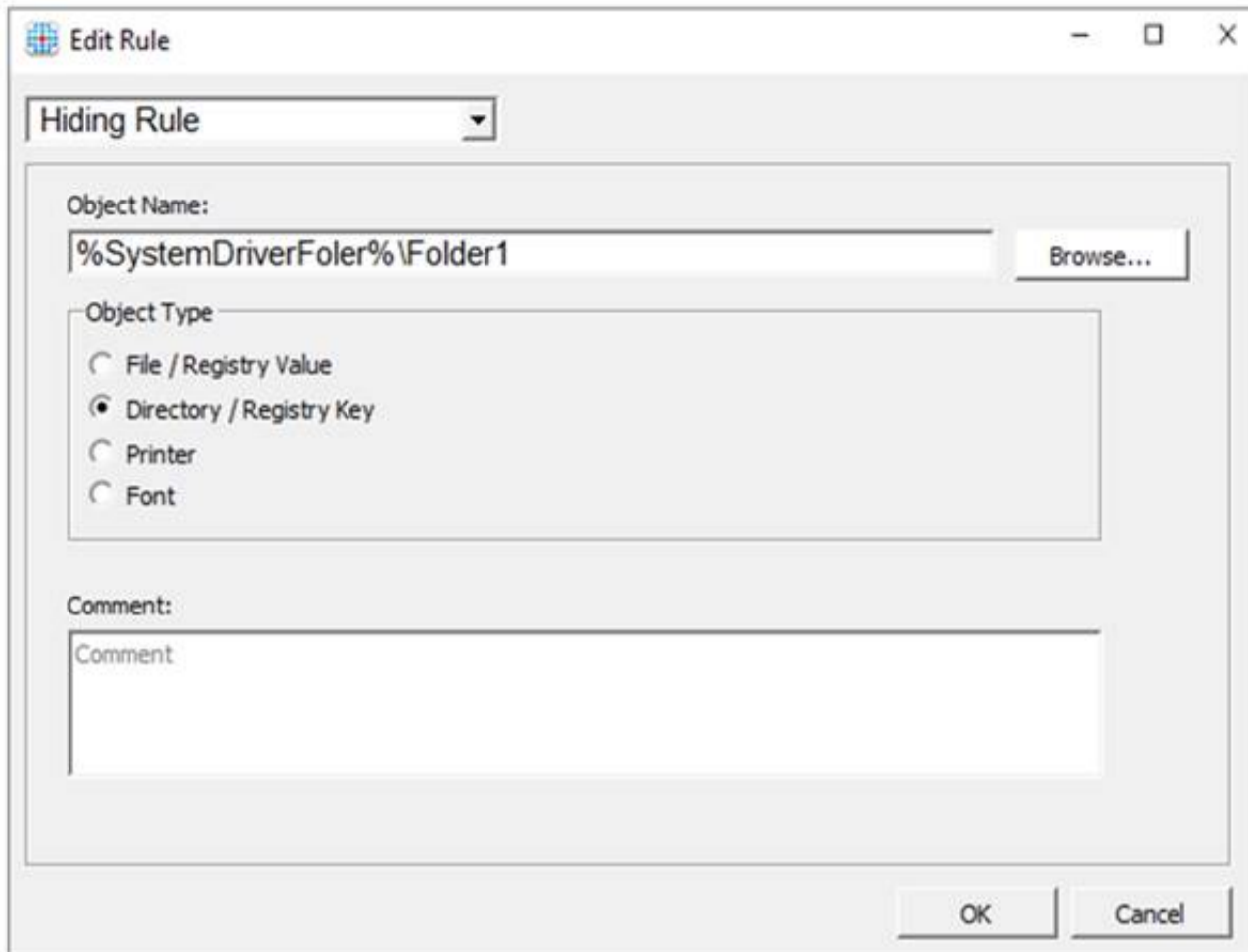

You create assignments for the Application Masking rule as shown in the following exhibit.

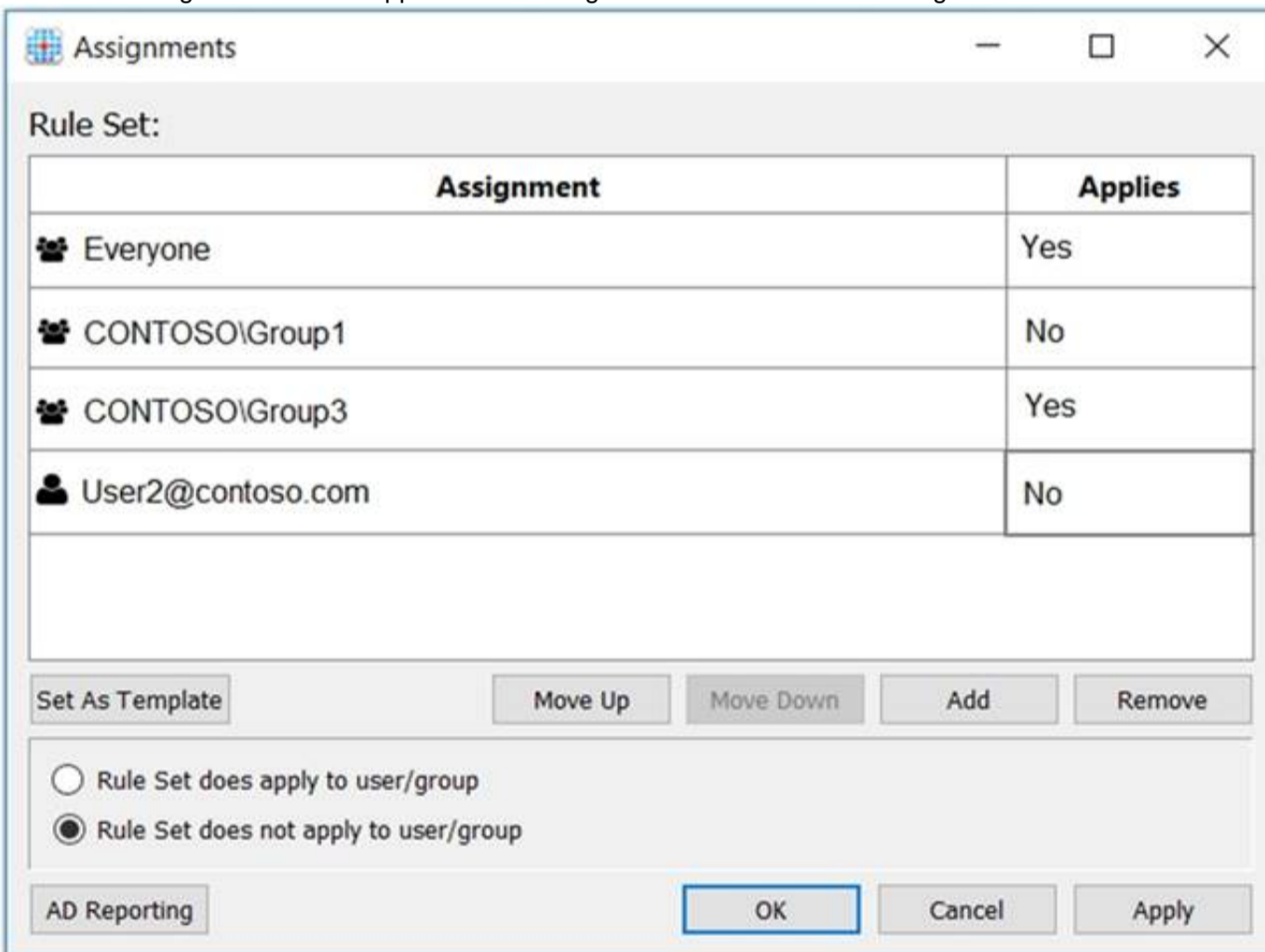

For each of the following statements, select Yes if the statement is true. Otherwise, select No.
 NOTE: Each correct selection is worth one point.

Answer Area

| Statements | Yes | No |
|--|-----------------------|-----------------------|
| User1 can see folder C:\Folder1 on a session host. | <input type="radio"/> | <input type="radio"/> |
| User2 can see folder C:\Folder1 on a session host. | <input type="radio"/> | <input type="radio"/> |
| User3 can see folder C:\Folder1 on a session host. | <input type="radio"/> | <input type="radio"/> |

Solution:

Graphical user interface, text Description automatically generated

References:

<https://docs.microsoft.com/en-us/fslogix/application-masking-rules-ht> <https://docs.microsoft.com/en-us/fslogix/application-masking-users-groups-ht>

Does this meet the goal?

- A. Yes
- B. No

Answer: A

NEW QUESTION 14

- (Topic 3)

You have an Azure Virtual Desktop host pool named Pool1 that contains three session hosts. The session hosts are configured to use FSLogix profiles. On a management computer, you create an Application Masking rule and assignment files. You need to apply Application Masking to the session hosts in Pool1. What should you do?

- A. Generate a registration token.
- B. Install the FSLogix agent on the session hosts in Pool1.
- C. Compile the rule and assignment files.
- D. Copy the files to the session hosts in Pool1.

Answer: D

Explanation:

Reference:

<https://cloudbuild.co.uk/fslogix-application-masking-in-windows-virtual-desktop/>

NEW QUESTION 15

HOTSPOT - (Topic 1)

Which users can create Pool4, and which users can join session hosts to the domain? To answer, select the appropriate options in the answer area.

NOTE: Each correct selection is worth one point.

Can create Pool4:

| |
|------------------------------------|
| Admin2 only |
| Admin2 and Admin4 only |
| Admin1, Admin2, and Admin4 only |
| Admin2, Admin3, and Admin4 only |
| Admin1, Admin2, Admin3, and Admin4 |

Can join session hosts to the domain:

| |
|-------------------------------------|
| Operator1 only |
| Admin1 and Admin3 only |
| Operator1 and Admin1 only |
| Operator1 and Operator3 only |
| Operator1, Operator2, and Operator3 |

Solution:

Can create Pool4:

| |
|------------------------------------|
| Admin2 only |
| Admin2 and Admin4 only |
| Admin1, Admin2, and Admin4 only |
| Admin2, Admin3, and Admin4 only |
| Admin1, Admin2, Admin3, and Admin4 |

Can join session hosts to the domain:

| |
|-------------------------------------|
| Operator1 only |
| Admin1 and Admin3 only |
| Operator1 and Admin1 only |
| Operator1 and Operator3 only |
| Operator1, Operator2, and Operator3 |

Does this meet the goal?

- A. Yes
- B. No

Answer: A

NEW QUESTION 16

- (Topic 3)

You have a Windows Virtual Desktop deployment. You publish a RemoteApp named AppVersion1. You need AppVersion1 to appear in the Remote Desktop client as Sales Contact Application. Which PowerShell cmdlet should you use?

- A. New-AzADApplication
- B. Update-AzWvdApplicationGroup
- C. Register-AzWvdApplicationGroup
- D. Update-AzWvdApplication

Answer: D

Explanation:

Reference:

<https://docs.microsoft.com/en-us/azure/virtual-desktop/customize-feed-for-virtual-desktop-users>

<https://docs.microsoft.com/en-us/powershell/module/az.desktopvirtualization/update-azwvdapplication?view=azps-5.7.0>

NEW QUESTION 17

- (Topic 3)

You have a Windows Virtual Desktop host pool named Pool1 and an Azure Automation account named account1. Pool1 is integrated with an Azure Active Directory Domain Services (Azure AD DS) managed domain named contoso.com.

You plan to configure scaling for Pool1 by using Azure Automation runbooks.

You need to authorize the runbooks to manage the scaling of Pool1. The solution must minimize administrative effort.

What should you configure?

- A. a managed identity in Azure Active Directory (Azure AD)
- B. a group Managed Service Account (gMSA) in Azure AD DS
- C. a Connections shared resource in Azure Automation
- D. a Run As account in Azure Automation

Answer: D

Explanation:

Reference:

<https://docs.microsoft.com/en-us/azure/virtual-desktop/set-up-scaling-script>

NEW QUESTION 18

HOTSPOT - (Topic 3)

You have an Azure Virtual Desktop deployment that contains two users named User1 and User2 and the storage accounts shown in the following table.

| Name | Role |
|----------|---|
| storage1 | Storage File Data SMB Share Contributor assigned to User1 Storage File Data SMB Share Elevated Contributor assigned to User2 |
| storage2 | Storage File Data SMB Share Contributor assigned to User1 Owner assigned to User2 |

The File share settings for storage1 are configured as shown in the following exhibit.

The File share settings for storage2 are configured as shown in the following exhibit.

For each of the following statements, select Yes if the statement is true. Otherwise, select No.

NOTE: Each correct selection is worth one point. Hot Area:

Answer Area

| Statements | Yes | No |
|---|-----------------------|-----------------------|
| User1 can access share1 by using Windows credentials. | <input type="radio"/> | <input type="radio"/> |
| User2 can access share4 by using Windows credentials. | <input type="radio"/> | <input type="radio"/> |
| User2 can enable SMB Multichannel for storage2. | <input type="radio"/> | <input type="radio"/> |

Solution:

YES, Yes , Yes

<https://docs.microsoft.com/en-us/azure/storage/files/storage-files-identity-ad-ds-assign-permissions?tabs=azure-portal> "Once you've enabled Active Directory Domain Services (AD DS) authentication on your storage account, you must configure share-level permissions in order to get access to your file shares. There are two ways you can assign share-level permissions. You can assign them to specific Azure AD users/user groups and you can assign them to all authenticated identities as a default share level permission."

Does this meet the goal?

- A. Yes
- B. No

Answer: A

NEW QUESTION 19

.....

Thank You for Trying Our Product

We offer two products:

1st - We have Practice Tests Software with Actual Exam Questions

2nd - Questions and Answers in PDF Format

AZ-140 Practice Exam Features:

- * AZ-140 Questions and Answers Updated Frequently
- * AZ-140 Practice Questions Verified by Expert Senior Certified Staff
- * AZ-140 Most Realistic Questions that Guarantee you a Pass on Your FirstTry
- * AZ-140 Practice Test Questions in Multiple Choice Formats and Updatesfor 1 Year

100% Actual & Verified — Instant Download, Please Click
[Order The AZ-140 Practice Test Here](#)